

NS-601 針床 Pinning Table



- 定位針床將布片每層按位排放
- 活動升降板，使插針能依照布厚度升降
- 木檯面能任意鑽孔
- 檯面備橫直線條方便對位
- 插針能任意取出

選購件：

NS-6202S-2M/ NS-6212S-2M

NS-6203C-2M/ NS-6213C-2M

- Pinning table can set layers of fabric in position
- Uplifttable platform can adjust needle height according to fabric thickness
- Wooden table, allowed to drill holes according to your need
- Table top with vertical and horizontal lines for positioning
- Pin can be taken out easily

Options:

NS-6202S-2M/ NS-6212S-2M

NS-6203C-2M/ NS-6213C-2M

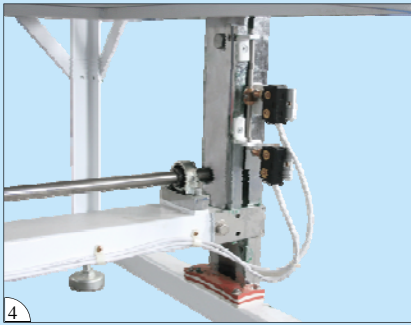
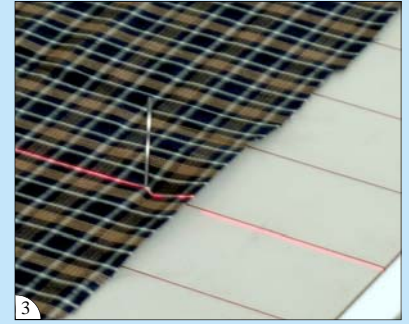
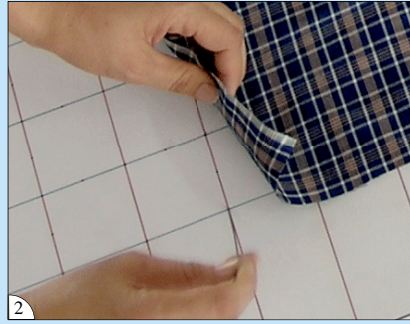
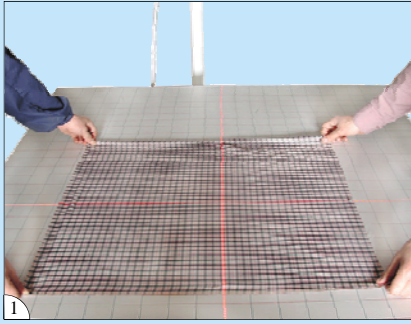

1. 對格
 2. 插針
 3. 固定布匹
 4. 針板上升/下降微動開關
1. Check matching
 2. Put in pin
 3. Fix fabric
 4. Uplift table platform lifting micro switch

選購件:

5. NS-6202S-2M直線鐳射燈
NS-6212S-2M直線鐳射燈
6. NS-6203C-2M十字鐳射燈
NS-6213C-2M十字鐳射燈

Optionals:

5. NS-6202S-2M Straight laser marker
NS-6212S-2M Straight laser marker
6. NS-6203C-2M Cross laser marker
NS-6213C-2M Cross laser marker

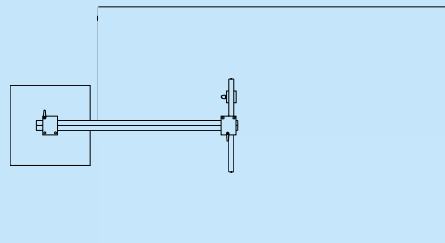
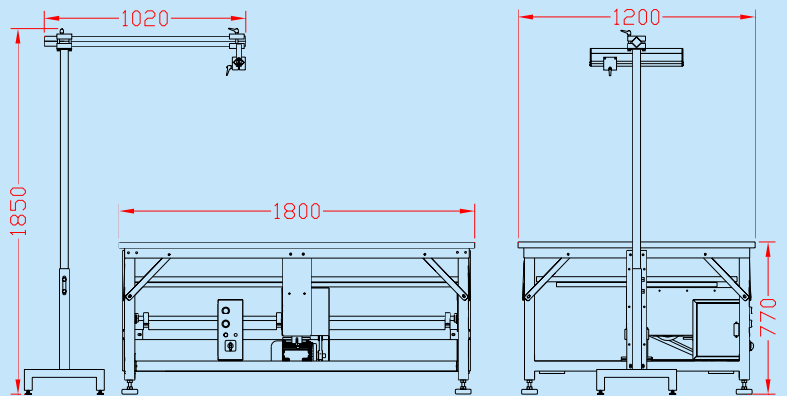

型號 Model	電源 Power Supply	總功率(kW) Total Power	檯面尺寸(mm) Table Size	淨重(kg) Net Weight	毛重(kg) Gross Weight	裝箱尺寸(mm) Packing Size
NS-601	1PH/220V/50Hz	0.2	1200x1800	280	388	2110x1340 x950



**藝誠(余氏)發展有限公司
Ngai Shing Development Limited**

香港九龍長沙灣永康街52號地下
G/F., 52 Wing Hong St.,
Cheung Sha Wan, Kln., Hong Kong.

Tel: (852) 2741 9981, 2742 0078 E-MAIL: info@ngaishing.com
Fax: (852) 2785 3149 Http://www.ngaishing.com